

P	LTR	DESCRIPTION	DATE	DWN	APVD
A		Initial Release	10MAR2025	M.S	J.M

NOTES:

- 1,Current Rating: See Table
- 2,Contact Resistance: 20mΩ Max
- 3,Withstand Voltage: 500V AC
- 4,Insulation Resistance: 100MΩ Min
- 5,Operation Temperature: -40°C to +125°C
- 6,Material: Phosphor Bronze
- 7,Plating: Tin or 0.8u" Gold over Nickel
- 8,Wire Range: 26#~30#AWG.
- 9,Insulation O.D: 1.02mm Max.

Size Wire	Current Rating
AWG#26	3.6A
AWG#28	3.1A
AWG#30	2.8A

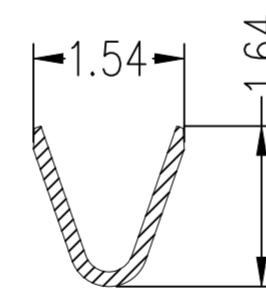
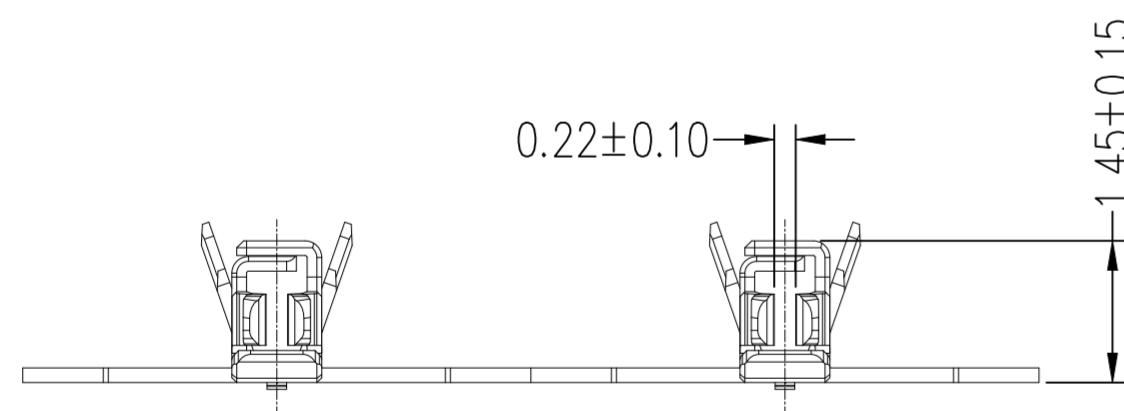
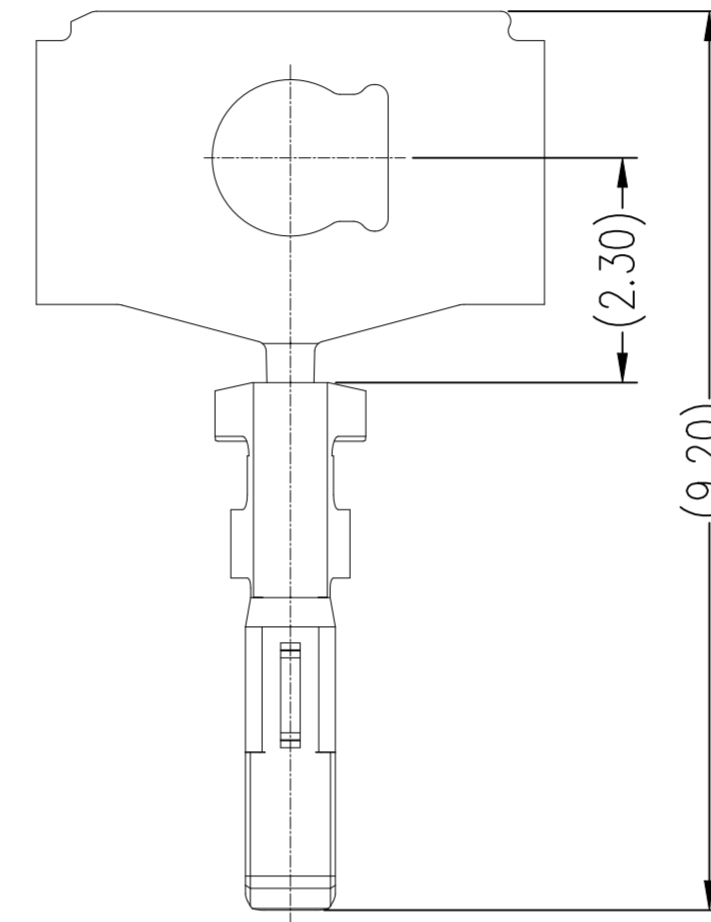
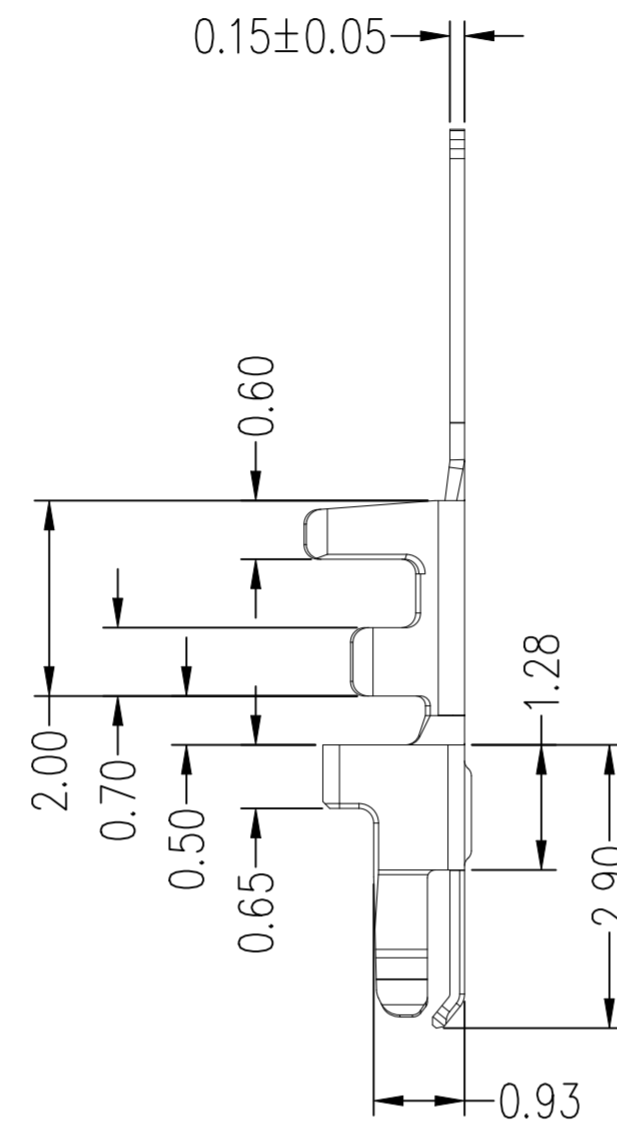
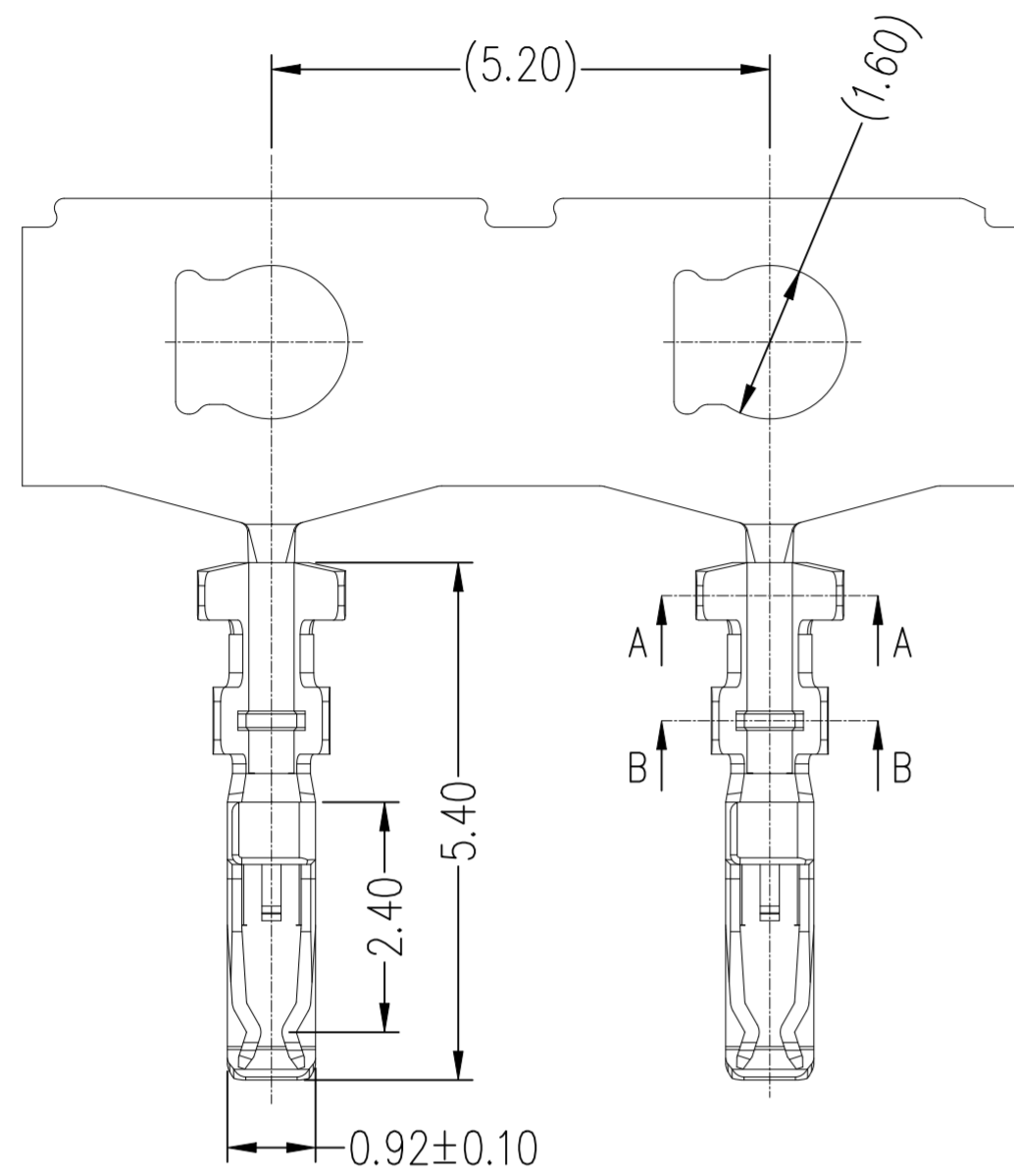

SECTION A-A

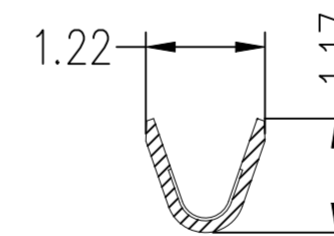

SECTION B-B

0.8u" Gold	2502607-2
Tin	2502607-1
PLATING	PN
PRODUCT FAMILY TABLE	

THIS DRAWING IS A CONTROLLED DOCUMENT.		DWN	MADHAN_S	17FEB2025	TE TE Connectivity	
DIMENSIONS:		CHK	JAGRUTI_M	17FEB2025		
mm [INCHES]		APVD	JAGRUTI_M	17FEB2025		
TOLERANCES UNLESS OTHERWISE SPECIFIED:		PRODUCT SPEC	108-161761	NAME		1.25MM TERMINAL
0 PLC	± -	APPLICATION SPEC		SIZE	A2	
1 PLC	± -			CAGE CODE	00779	
2 PLC	± 0.25			DRAWING NO	C=2502607	
3 PLC	± -			RESTRICTED TO	-	
4 PLC	± -			SCALE	1:1	
ANGLES	± -			SHEET	1 OF 2	
MATERIAL	See Note	FINISH	See Note	WEIGHT	0	
CUSTOMER DRAWING		SCALE		1:1	REV	A

REVISIONS					
P	LTR	DESCRIPTION	DATE	DWN	APVD
-	-	SEE SHEET 1	-	-	-

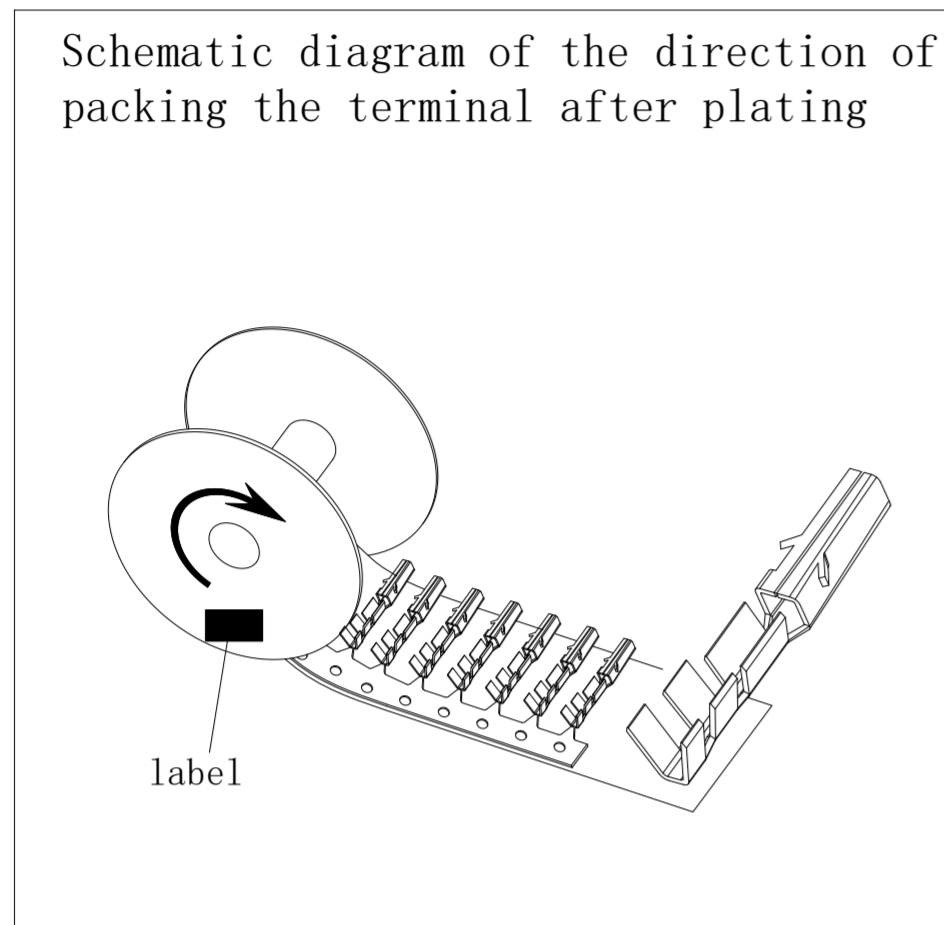

The outermost paper tape

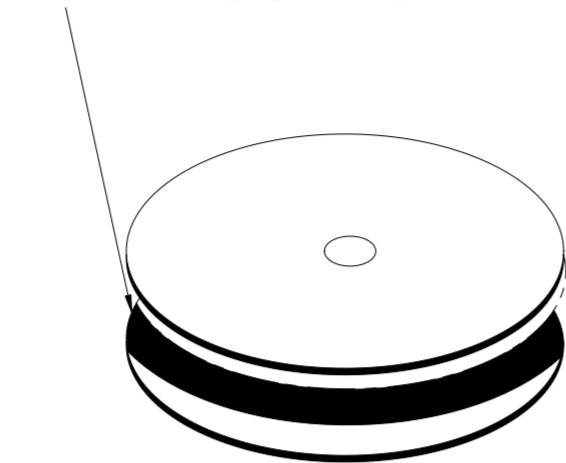

No.1:Roll the terminal into the paper tray,20KPIN/Tray
 The outermost layer is protected by T=0.5 paper tape
 Paper Tray Specification:CTN-ZP03(560*560mm) with CTN-16
 Remarks: 1.The gap between the paper tape and tray is less than 1mm,to reduce the shaking of the terminal in the paper tray
 2. The paper tape should be tightly wound with the terminal to prevent loosening;



No.2:Label the paper tray

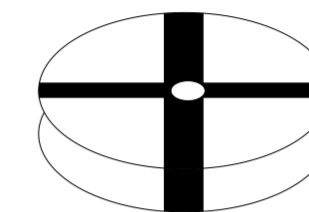

No.3:The stack of all trays in each box is fixed with PE film(8 trays/carton)

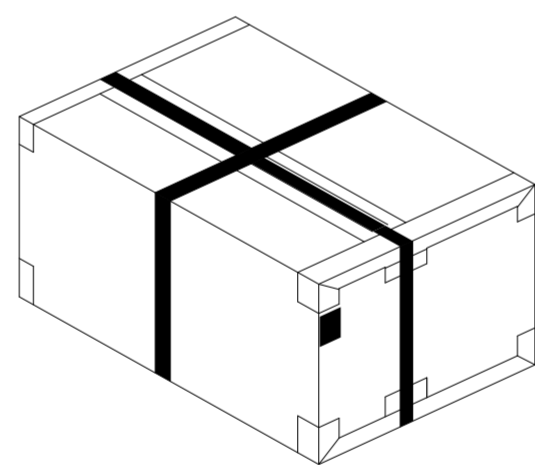

No.6:Packing belt

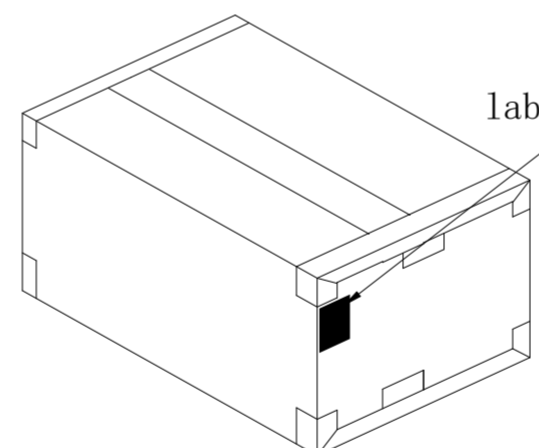

No.5: Seal the carton and label the outer one

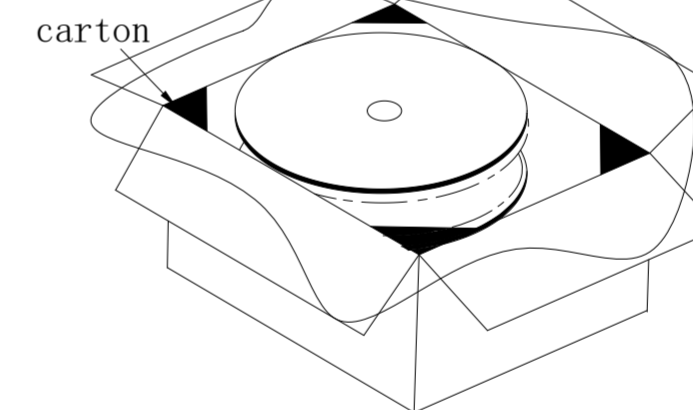

No.4:Inside the carton need to set waterproof bag PE-44, and then put the terminal into the carton put two packets of desiccant and then sealed, Pplace paper corner guards at the four corners of the carton
 Paper Tray Specification:CTN-16(56.5*56.5*22.5cm) with CTN-J035

Remarks:

- Put the product into the terminal paper tray as shown in the figure
- Pay attention to the consistency of label style, position and direction;

THIS DRAWING IS A CONTROLLED DOCUMENT.		DWN MADHAN_S 17FEB2025			
DIMENSIONS: mm [INCHES]		CHK JAGRUTI_M 17FEB2025			
TOLERANCES UNLESS OTHERWISE SPECIFIED:		APVD JAGRUTI_M 17FEB2025	NAME		
0 PLC ± -		PRODUCT SPEC	-		
1 PLC ± -		108-161761	1.25MM TERMINAL		
2 PLC ± 0.25		APPLICATION SPEC	-		
3 PLC ± -		WEIGHT 0	SIZE A2	CAGE CODE 00779	DRAWING NO C=2502607
4 PLC ± -		FINISH See Note	RESTRICTED TO		
ANGLES ± -		MATERIAL See Note	-		
		CUSTOMER DRAWING	SCALE 1:1	SHEET 2 of 2	REV A