

# SMCJ

## Automotive grade 1500 W Transient voltage suppressor

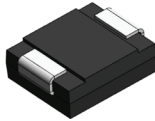

### Product features

- Automotive grade (AEC-Q101 qualified)
- Low profile SMC package
- Excellent clamping capability
- High reliability application
- 1500 W peak pulse power capability at 10/1000  $\mu$ s waveform
- Typical  $I_R$  less than 1  $\mu$ A
- Fast response time: typically less than 1.0 ps from 0 V to  $V_{BR}$  minimum
- Plastic package meets UL 94 V-0 flammability rating
- Meets moisture sensitivity level (MSL) level 1
- Terminal: tin plated, solderable per J-STD-002
- UL 497B recognized.  
File No. : E198449 Guide QVGQ2

### PIN configuration

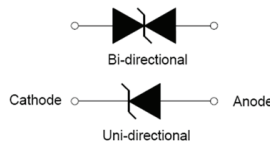
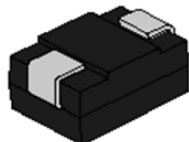

### Applications

- Automotive chassis and safety systems
- Advanced driver assistance systems (ADAS)
- Communication and infotainment systems
- Network systems and body electronics
- Power Train controls
- xEV and battery systems

### Environmental compliance and general specifications

- AEC-Q101 qualified



### Ordering part number

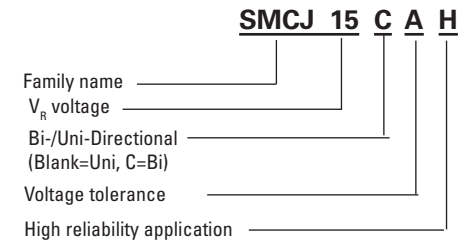

### Alternate ordering part number

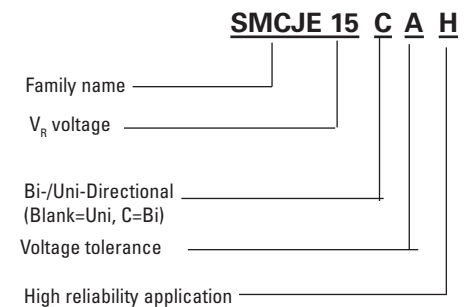

### Absolute maximum ratings

(+25 °C, RH=45%-75%, unless otherwise noted)

Parameter	Symbol	Value	Unit
Storage operating junction temperature range	$T_{STG}/T_J$	-55 to +150	°C
Steady state power dissipation at $T_L = +75$ °C	$P_{M(AV)}$	6.5	W
Peak pulse power dissipation on 10/1000 $\mu$ s waveform	$P_{PP}$	1500	W
Maximum instantaneous forward voltage at 100 A for unidirectional	$V_F$	5	V
Peak forward surge current, 8.3 ms single half sine wave <sup>1</sup>	$I_{FSM}$	200	A
Typical thermal resistance junction to lead	$R_{\theta_{JL}}$	15	°C/W
Typical thermal resistance junction to ambient	$R_{\theta_{JA}}$	75	°C/W

1. Measured on 8.3 ms single half sine wave or equivalent square wave for unidirectional device only, duty cycle = 4 per minute maximum

### Mechanical parameters, pad layout- mm/inches

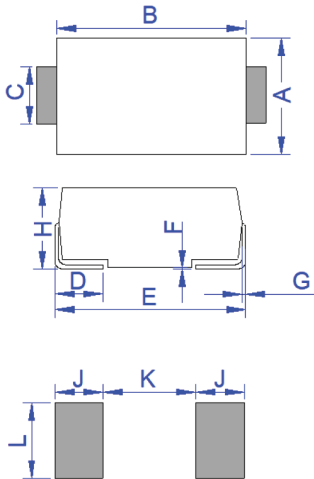

Dimension	Millimeters		Inches	
	Minimum	Maximum	Minimum	Maximum
A	5.75	6.25	0.226	0.246
B	6.90	7.40	0.272	0.291
C	2.75	3.25	0.108	0.128
D	0.95	1.52	0.037	0.060
E	7.70	8.20	0.303	0.323
F	0.051	0.203	0.002	0.008
G	0.15	0.31	0.006	0.012
H	2.15	2.62	0.085	0.103
J	2.40	-	0.094	-
K	-	4.20	-	0.165
L	3.30	-	0.130	-

### Part marking



Cathode band (uni-polar only)  
Part marking: xxx = Refer to marking designator listed in Electrical Characteristics table  
yyyy= date code

### Packaging information - mm/inches

Drawing not to scale.

Supplied in tape and reel packaging, 3,000 parts per 13" diameter reel (EIA-481 compliant)

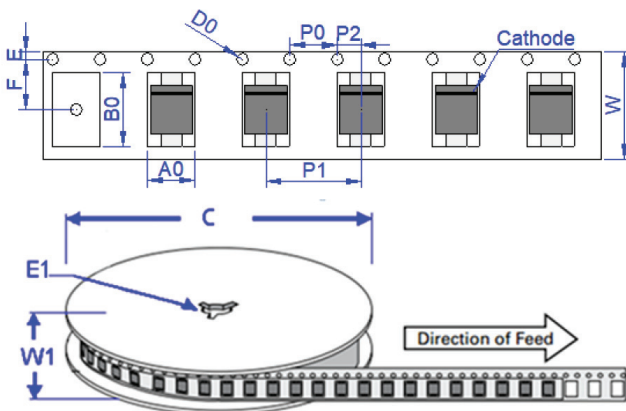

Dimensions	Millimeters	Inches
A0	6.05 ± 0.3	0.238 ± 0.012
B0	8.31 ± 0.3	0.327 ± 0.012
C	330.0	13.0
D0	1.55 ± 0.1	0.061 ± 0.004
E	1.75 ± 0.2	0.069 ± 0.008
E1	13.3 ± 0.3	0.524 ± 0.012
F	7.50 ± 0.2	0.295 ± 0.008
P0	4.00 ± 0.2	0.157 ± 0.008
P1	8.00 ± 0.2	0.3145 ± 0.008
P2	2.00 ± 0.2	0.079 ± 0.008
W	16.0 ± 0.2	0.630 ± 0.008
W1	19.7 ± 2.0	0.776 ± 0.079

Electrical specifications (+25 °C)

Part number		Marking		V <sub>R</sub> (V)	I <sub>R</sub> @ V <sub>R</sub> (μA)	V <sub>BR</sub> @ I <sub>T</sub>		I <sub>T</sub> (mA)	V <sub>C</sub> @ I <sub>PP</sub> max (V)	I <sub>PP</sub> (A)
Uni-polar	Bi-polar	Uni	Bi			min (V)	max (V)			
SMCJ15AH	SMCJ15CAH	GEM	BEM	15	1	16.7	18.5	1	24.4	61.5
SMCJ16AH	SMCJ16CAH	GEP	BEP	16	1	17.8	19.7	1	26	57.7
SMCJ17AH	SMCJ17CAH	GER	BER	17	1	18.9	20.9	1	27.6	54.4
SMCJ18AH	SMCJ18CAH	GET	BET	18	1	20	22.1	1	29.2	51.4
SMCJ20AH	SMCJ20CAH	GEV	BEV	20	1	22.2	24.5	1	32.4	46.3
SMCJ22AH	SMCJ22CAH	GEX	BEX	22	1	24.4	26.9	1	35.5	42.3
SMCJ24AH	SMCJ24CAH	GEZ	BEZ	24	1	26.7	29.5	1	38.9	38.6
SMCJ26AH	SMCJ26CAH	GFE	BFE	26	1	28.9	31.9	1	42.1	35.6
SMCJ28AH	SMCJ28CAH	GFG	BFG	28	1	31.1	34.4	1	45.4	33.1
SMCJ30AH	SMCJ30CAH	GFK	BFK	30	1	33.3	36.8	1	48.4	31
SMCJ33AH	SMCJ33CAH	GFM	BFM	33	1	36.7	40.6	1	53.3	28.2
SMCJ36AH	SMCJ36CAH	GFP	BFP	36	1	40	44.2	1	58.1	25.8
SMCJ40AH	SMCJ40CAH	GFR	BFR	40	1	44.4	49.1	1	64.5	23.3
SMCJ43AH	SMCJ43CAH	GFT	BFT	43	1	47.8	52.8	1	69.4	21.6
SMCJ45AH	SMCJ45CAH	GFV	BFV	45	1	50	55.3	1	72.7	20.6
SMCJ48AH	SMCJ48CAH	GFX	BFX	48	1	53.3	58.9	1	77.4	19.4
SMCJ51AH	SMCJ51CAH	GFZ	BFZ	51	1	56.7	62.7	1	82.4	18.2
SMCJ54AH	SMCJ54CAH	GGE	BGE	54	1	60	66.3	1	87.1	17.2
SMCJ58AH	SMCJ58CAH	GGG	BGG	58	1	64.4	71.2	1	93.6	16.1
SMCJ60AH	SMCJ60CAH	GGK	BGK	60	1	66.7	73.7	1	96.8	15.5
SMCJ64AH	SMCJ64CAH	GGM	BGM	64	1	71.1	78.6	1	103	14.6
SMCJ70AH	SMCJ70CAH	GGP	BGP	70	1	77.8	86	1	113	13.3
SMCJ75AH	SMCJ75CAH	GGR	BGR	75	1	83.3	92.1	1	121	12.4
SMCJ78AH	SMCJ78CAH	GGT	BGT	78	1	86.7	95.8	1	126	11.9
SMCJ85AH	SMCJ85CAH	GGV	BGV	85	1	94.4	104	1	137	11
SMCJ90AH	SMCJ90CAH	GGX	BGX	90	1	100	111	1	146	10.3
SMCJ100AH	SMCJ100CAH	GGZ	BGZ	100	1	111	123	1	162	9.3
SMCJ110AH	SMCJ110CAH	GHE	BHE	110	1	122	135	1	177	8.5
SMCJ120AH	SMCJ120CAH	GHG	BHG	120	1	133	147	1	193	7.8
SMCJ130AH	SMCJ130CAH	GHK	BHK	130	1	144	159	1	209	7.2
SMCJ150AH	SMCJ150CAH	GHM	BHM	150	1	167	185	1	243	6.2
SMCJ160AH	SMCJ160CAH	GHP	BHP	160	1	178	197	1	259	5.8
SMCJ170AH	SMCJ170CAH	GHR	BHR	170	1	189	209	1	275	5.5
SMCJ180AH	SMCJ180CAH	GHT	BHT	180	1	201	222	1	292	5.2
SMCJ190AH	SMCJ190CAH	GHU	BHU	190	1	211	234	1	307	4.9
SMCJ200AH	SMCJ200CAH	GHV	BHV	200	1	224	247	1	324	4.7
SMCJ210AH	SMCJ210CAH	GHW	BHW	210	1	233	258	1	337	4.5
SMCJ220AH	SMCJ220CAH	GHX	BHX	220	1	246	272	1	356	4.2
SMCJ250AH	SMCJ250CAH	GJG	BJG	250	1	279	309	1	405	3.7
SMCJ300AH	SMCJ300CAH	GJK	BJK	300	1	335	371	1	486	3.1
SMCJ350AH	SMCJ350CAH	GJM	BJM	350	1	391	432	1	567	2.7
SMCJ400AH	SMCJ400CAH	GJP	BJP	400	1	447	494	1	648	2.3
SMCJ440AH	SMCJ440CAH	GJR	BJR	440	1	492	543	1	713	2.1

Note: Standard part numbers listed. Alternate part numbers have the addition of an E and a "." for the "." where applicable. Example standard part number SMCJ15AH, Alternate part number SMCJE15AH

**Ratings and V-I characteristic curves** (+25 °C unless otherwise noted)

**V- I curve characteristics (Uni-directional)**

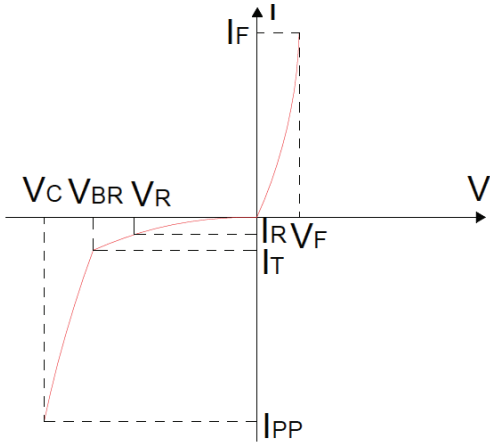

**V- I curve characteristics (Bi-directional)**

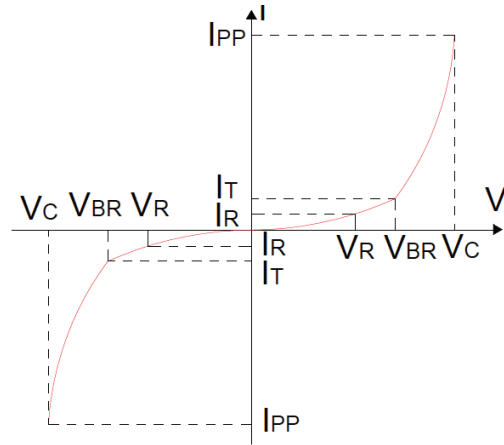

Surge waveform: 10/1000  $\mu$ s

$V_R$ : Stand-off voltage – Maximum voltage that can be applied

$V_{BR}$ : Breakdown voltage

$V_C$ : Clamping voltage – Peak voltage measured across the suppressor at a specified  $I_{PP}$

$I_R$ : Reverse leakage current

$I_T$ : Test current

$V_F$ : Forward voltage drop for Uni-directional

**Pulse waveform**

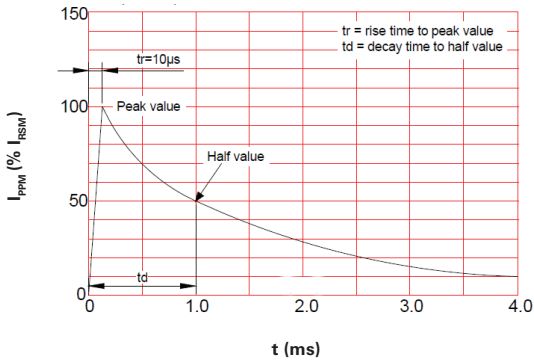

**Pulse derating curve**

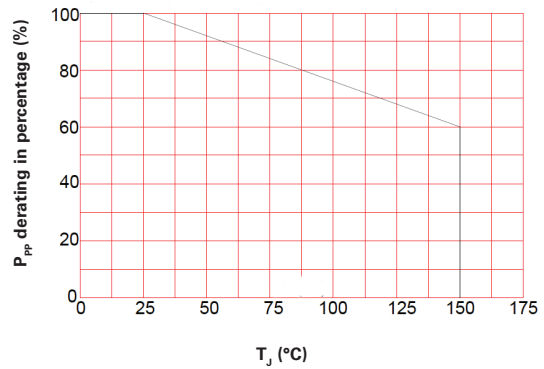

**Peak pulse power dissipation curve**

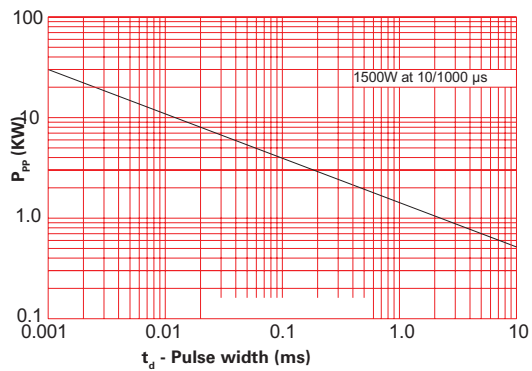

Solder reflow profile

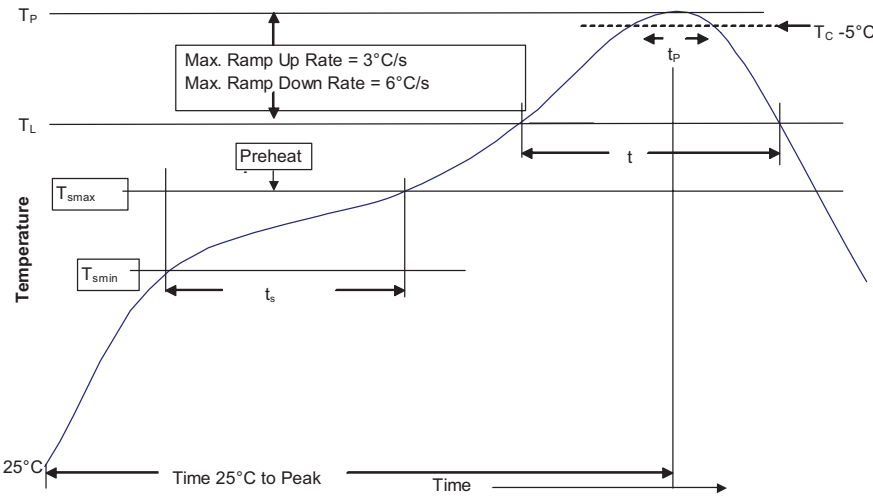

Table 1 - Standard SnPb solder ( $T_C$ )

Package thickness	Volume mm <sup>3</sup> <350	Volume mm <sup>3</sup> ≥350
<2.5 mm	235 °C	220 °C
≥2.5 mm	220 °C	220 °C

Table 2 - Lead (Pb) free solder ( $T_C$ )

Package thickness	Volume mm <sup>3</sup> <350	Volume mm <sup>3</sup> 350 - 2000	Volume mm <sup>3</sup> >2000
<1.6 mm	260 °C	260 °C	260 °C
1.6 – 2.5 mm	260 °C	250 °C	245 °C
>2.5 mm	250 °C	245 °C	245 °C

Reference J-STD-020

Profile feature	Standard SnPb solder	Lead (Pb) free solder
Preheat and soak		
• Temperature min. ( $T_{smin}$ )	100 °C	150 °C
• Temperature max. ( $T_{smax}$ )	150 °C	200 °C
• Time ( $T_{smin}$ to $T_{smax}$ ) ( $t_s$ )	60-120 seconds	60 - 180 seconds
Ramp up rate $T_L$ to $T_p$	3 °C/ second max.	3 °C/ second max.
Liquidous temperature ( $T_L$ )	183 °C	217 °C
Time ( $t_L$ ) maintained above $T_L$	60-150 seconds	60-150 seconds
Peak package body temperature ( $T_p$ )*	Table 1	Table 2 (+0, -5 °C)
Time ( $t_p$ )* within 5 °C of the specified classification temperature ( $T_c$ )	20 seconds*	40 seconds*
Ramp-down rate ( $T_p$ to $T_L$ )	6 °C/ second max.	6 °C/ second max.
Time 25 °C to peak temperature	6 minutes max.	8 minutes max.

\* Tolerance for peak profile temperature ( $T_p$ ) is defined as a supplier minimum and a user maximum.

Life Support Policy: Eaton does not authorize the use of any of its products for use in life support devices or systems without the express written approval of an officer of the Company. Life support systems are devices which support or sustain life, and whose failure to perform, when properly used in accordance with instructions for use provided in the labeling, can be reasonably expected to result in significant injury to the user.

Eaton reserves the right, without notice, to change design or construction of any products and to discontinue or limit distribution of any products. Eaton also reserves the right to change or update, without notice, any technical information contained in this bulletin.

**Eaton**  
Electronics Division  
1000 Eaton Boulevard  
Cleveland, OH 44122  
United States  
Eaton.com/electronics

© 2024 Eaton  
All Rights Reserved  
Printed in USA  
Publication No. ELX1064  
September 2024

Eaton is a registered trademark.  
All other trademarks are property of their respective owners.

Follow us on social media to get the latest product and support information.

